

4

3

2

1

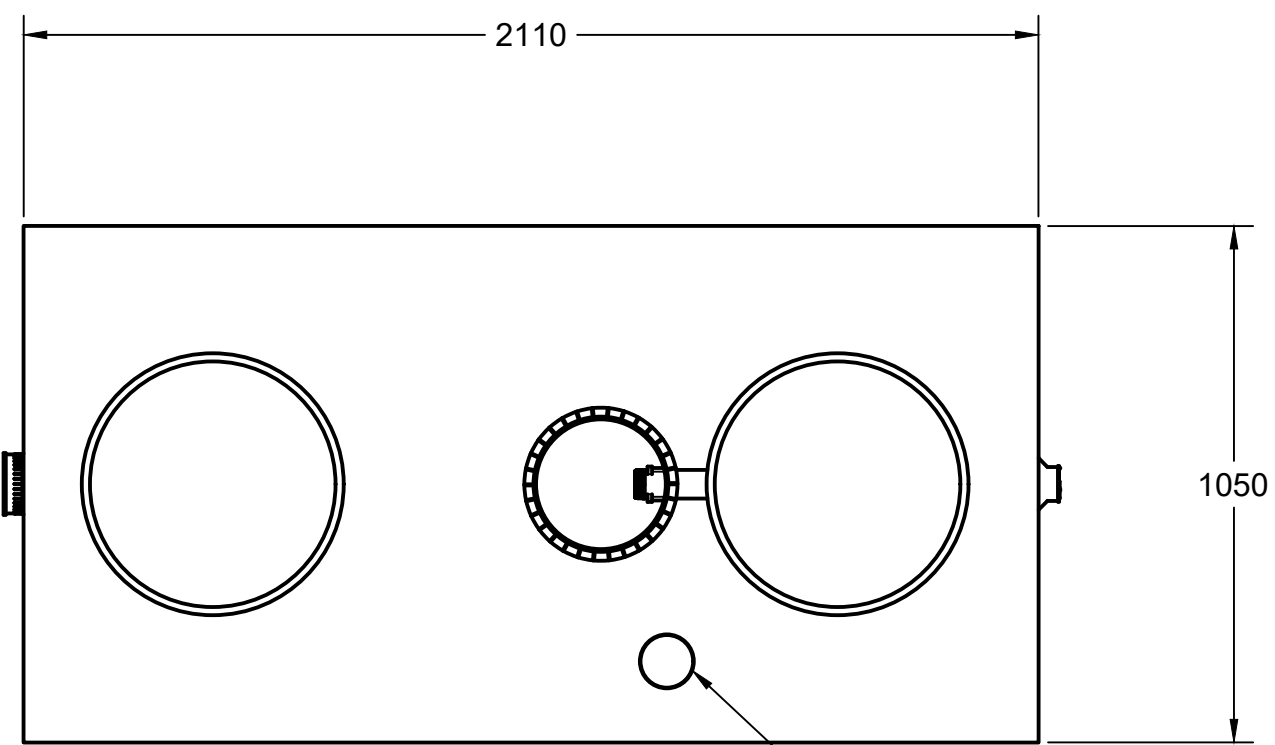

102Ø PVC Coupling Cast in Concrete for Vent

WORKING VOLUME 1775L

TOTAL VOLUME 2185L

CONCRETE
35 MPa w/ 5-8% air entrainment.
Non-sulphate resistant

REINFORCING
Body: 10M bar 600mm O/C E/W
Lid: 10M 4pcs Long / 5 pcs Latit. evenly spaced

WEIGHT
1810KGs

MAX BURIAL DEPTH
1.2m in a Non-Traffic Rated Location

WATER TIGHTNESS
Butyl mastic sealant between tank body and lid applied as per manufacturers recommended method.

PIPE/WALL CONNECTIONS
Inlet: 100mm flexible watertight rubber seal
Outlet: 500mm flexible watertight rubber seal

102Ø Flexible Rubber Inlet

508Ø Tuf-Tite Access Riser w/ 305Ø Tuf-Tite Riser for Electrical Connections

51Ø Flexible Rubber Outlet

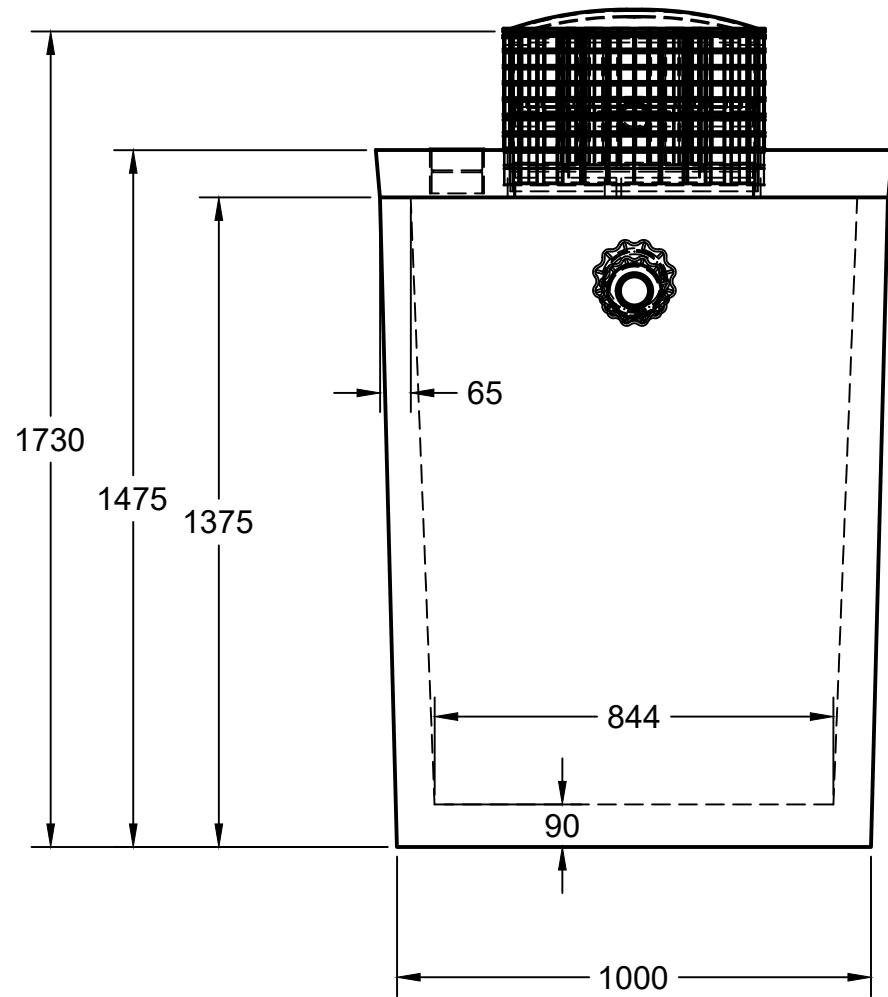
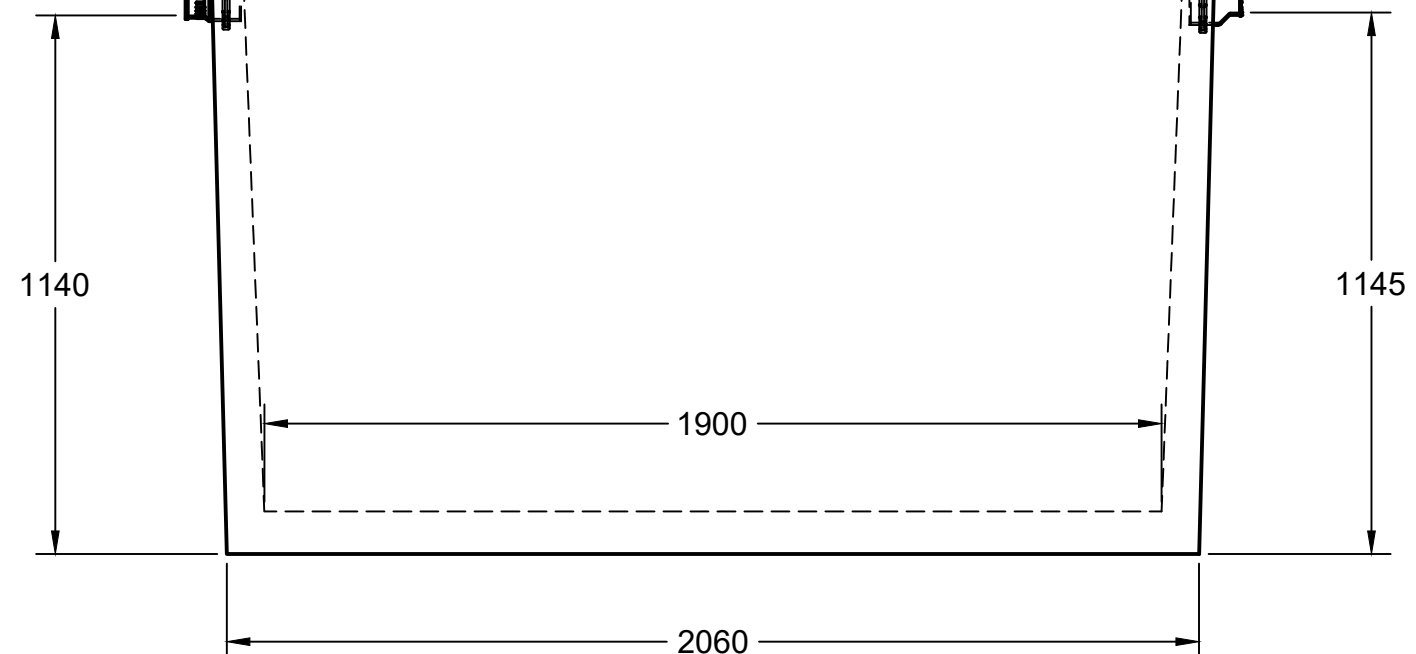

5450 Cuddy St Osgoode, ON K0A 2W0
tel: (613) 826.2318 fax: (613) 826.3679
toll free: 888.846.6664
website: www.boydbrosconcrete.ca
email: info@boydbrosconcrete.ca

PROJECT		
Boyd Bros Concrete		
TITLE		
1700L Pump Tank		
DRAWN Rob Sanna 8/27/24 APPROVED		
SIZE	DWG NAME	REV
C		3
SCALE 1:16	WEIGHT 1810kgs	SHEET 1/1

4

3

2

1

D

D

C

C

B

B

A

A